

SEÇÃO TRANSVERSAL TIPO (PAVIMENTO)

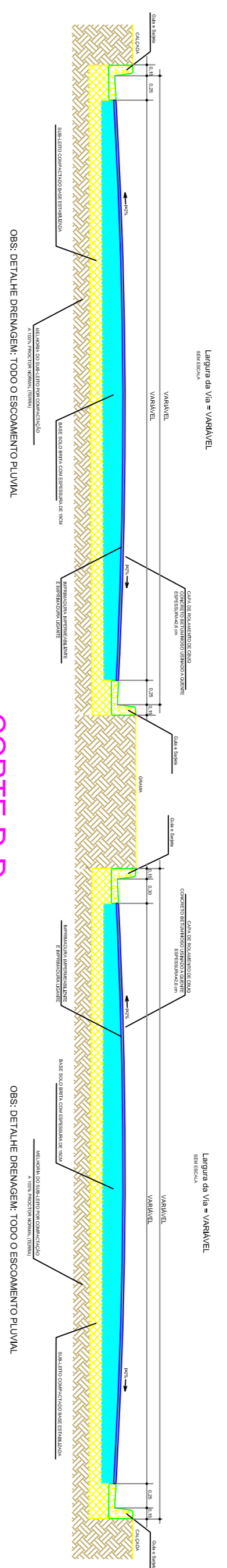

CORTE D-D

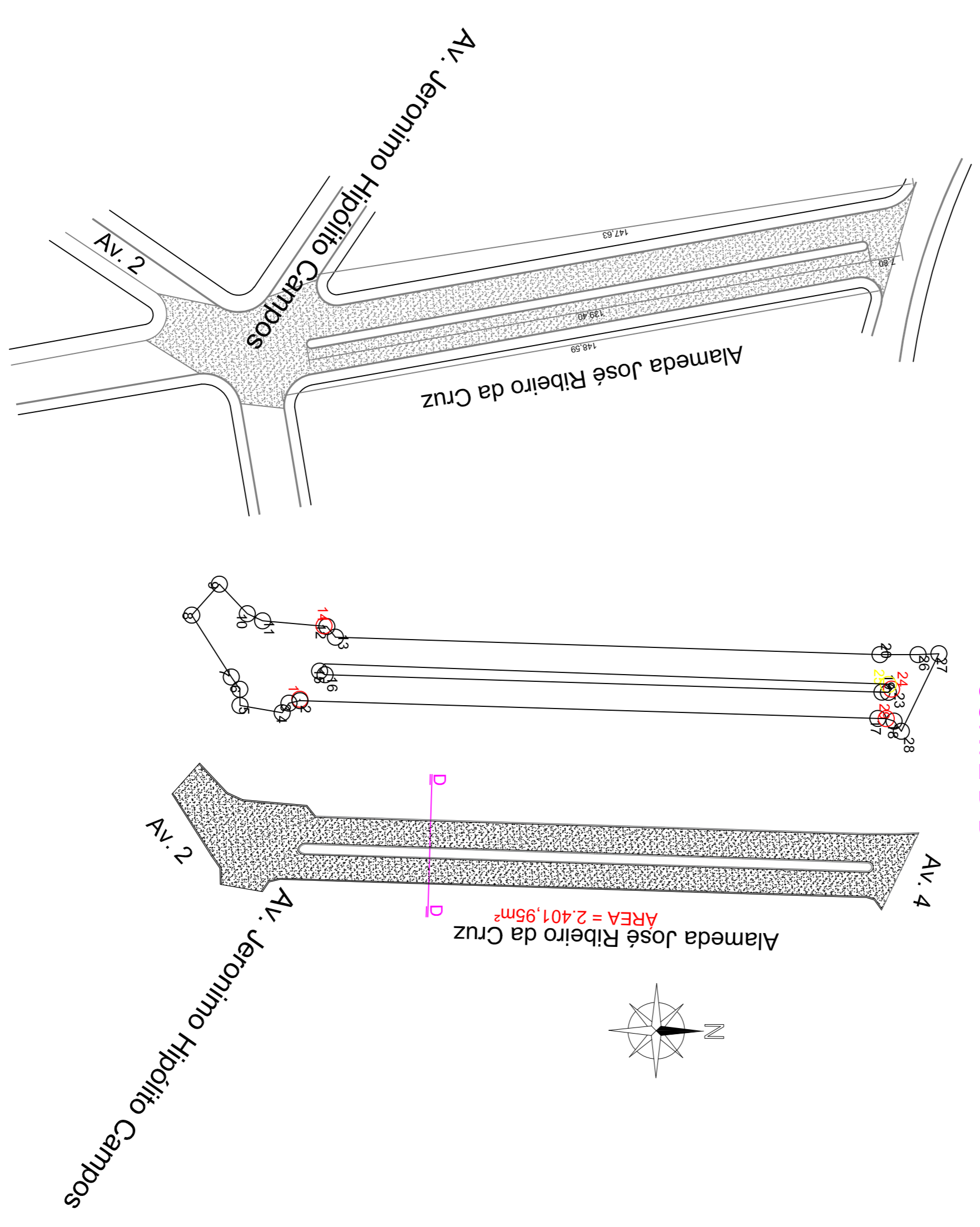

AV. 4

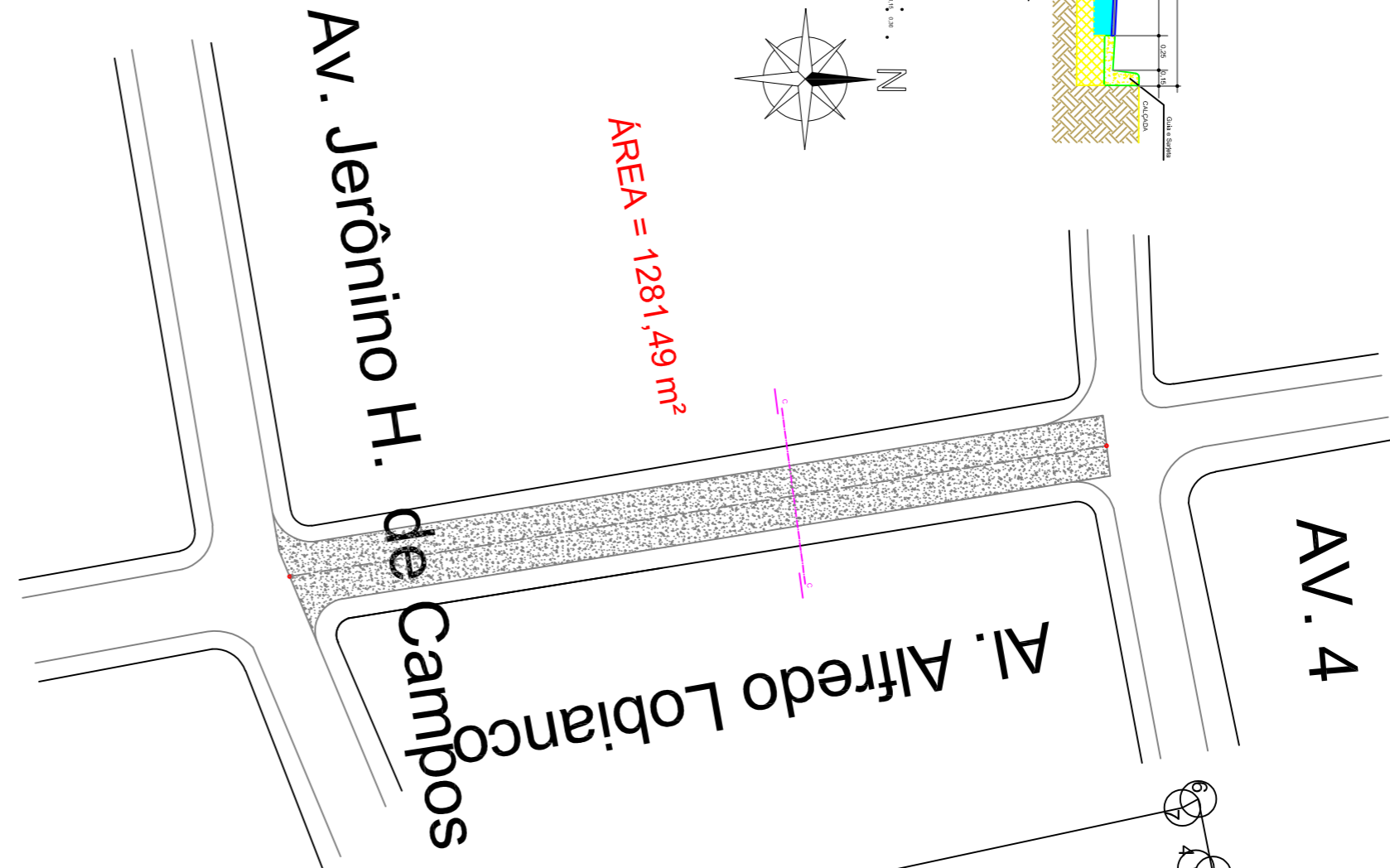

SEÇÃO TRANSVERSAL TIPO (RECAPEAMENTO)

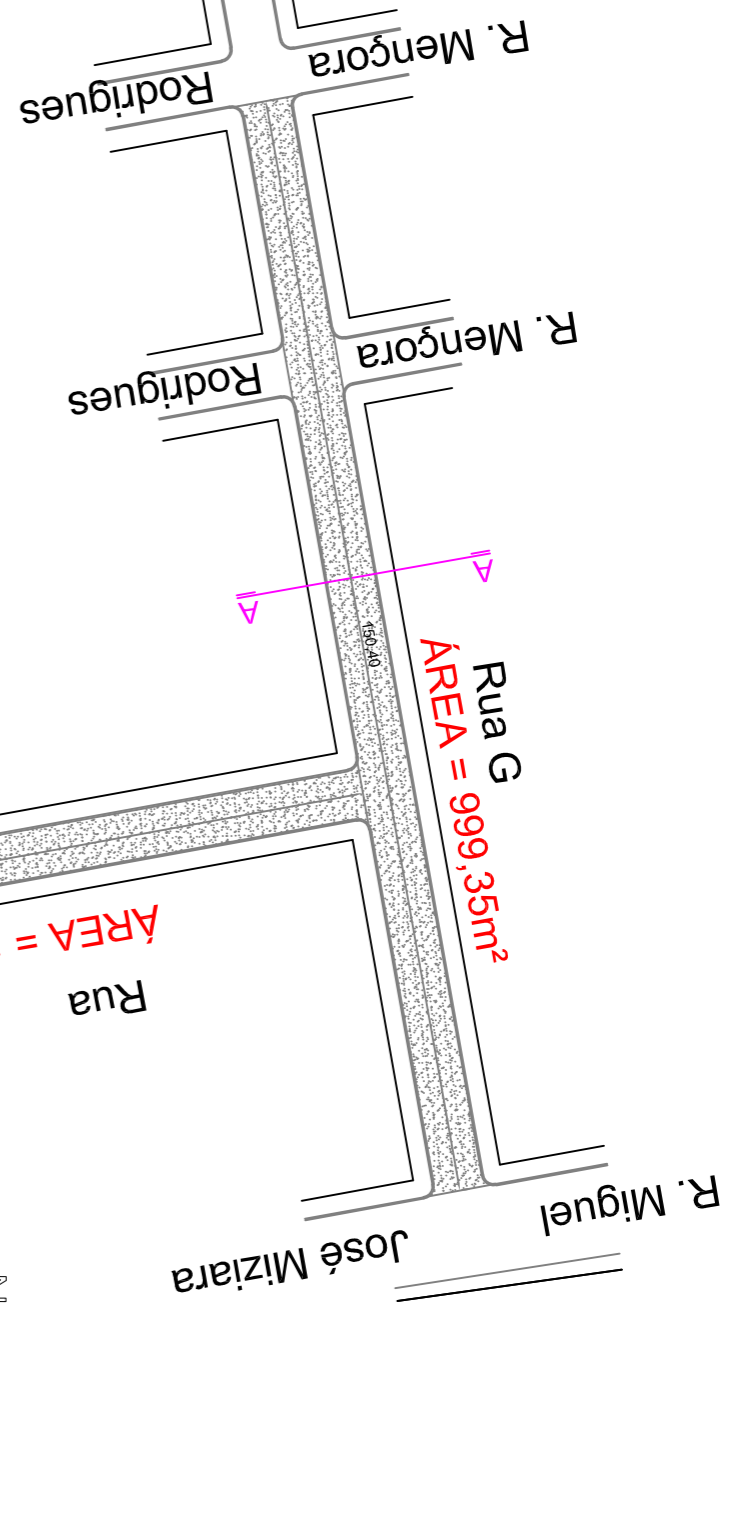

CORTE C-C

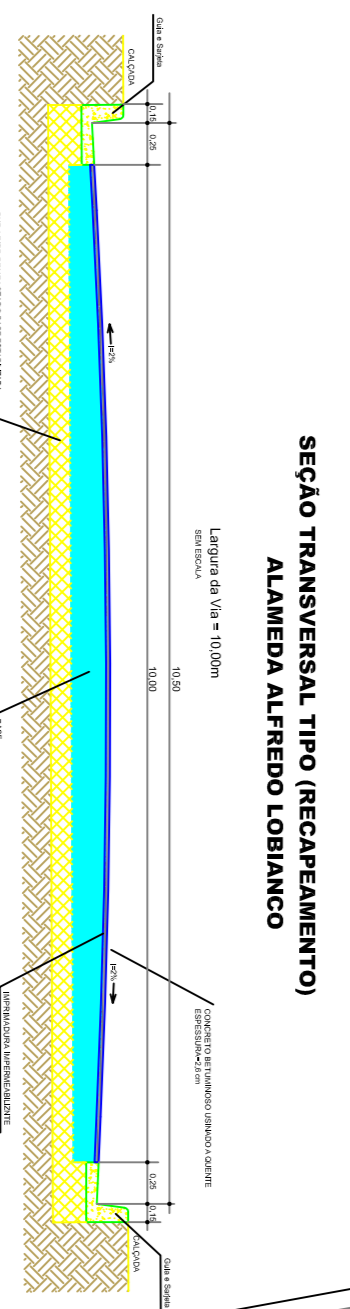

TOTAL RECAPEAMENTO = 6.868,33m²

SEÇÃO TRANSVERSAL TIPO (RECAPEAMENTO)

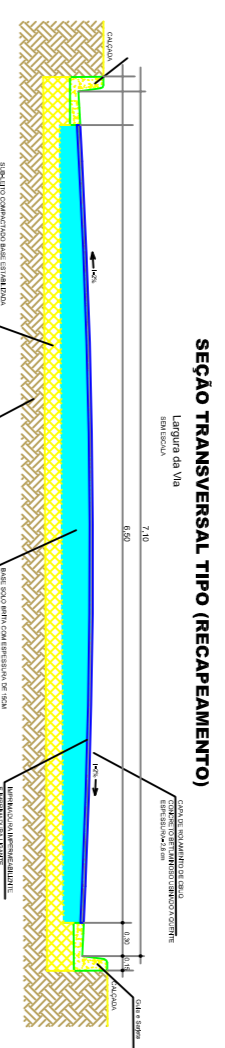

CORTE C-C

CORTE B-B

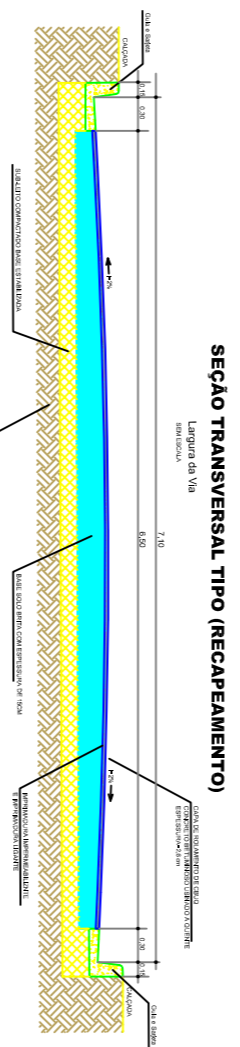

CORTE A-A

GOVERNO MUNICIPAL
FRONTEIRA
CUIDANDO DE NOSSA CIDADANIA
Ateliê: 2013/2020

Departamento de Engenharia e Obras - Fronteira - MG.

RECAPEAMENTO DE VIAS PÚBLICAS

MUNICÍPIO DE FRONTEIRA - MG.

RESP. TÉCNICO:	APROVADO:	DATA:
ALEX ALESSANDRO BORGES SOUZA	MARCELO MENDES PASSUELO ENGENHEIRO SUPERIOR DE TRIBUTAÇÃO	JULHO/2020
ESCALA:	INDICADAS	DESENHO:
VÍCIOS:	FL. 001/01	VITOR FERNANDO